

# Lugus HOMES



## Burridge Gardens, Clapham Junction

Asking price £497,500



This first-floor, west-facing apartment extends to approximately 539 sq ft and benefits from a private balcony, providing excellent afternoon and evening light.

The apartment forms part of One Clapham Junction, a high-quality residential development ideally located moments from Clapham Junction Station and the River Thames, and set between Clapham Common and Wandsworth Common.

Residents enjoy access to a 24-hour concierge, landscaped courtyard gardens and a fitness suite with Peloton facilities.

Built by Mount Anvil, One Clapham Junction is superbly connected, with Clapham Junction Station offering fast services to Victoria (6 minutes), Waterloo, Canary Wharf, King's Cross and Gatwick Airport. Wimbledon and Richmond are just two stops away.

Surrounded by excellent restaurants, cafés and shops, the area also offers easy access to Chelsea and Fulham via Battersea Bridge.

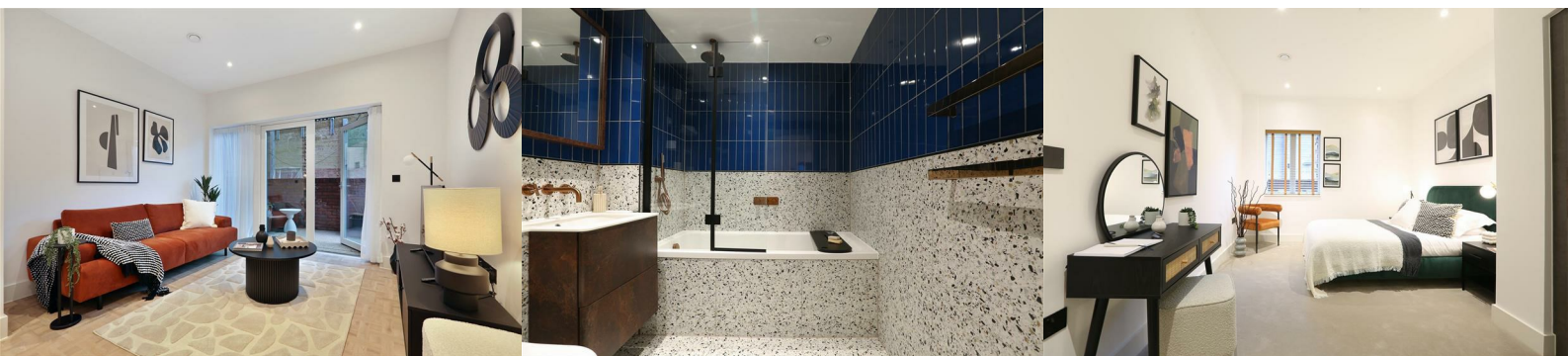

Area Map



Floor Plans

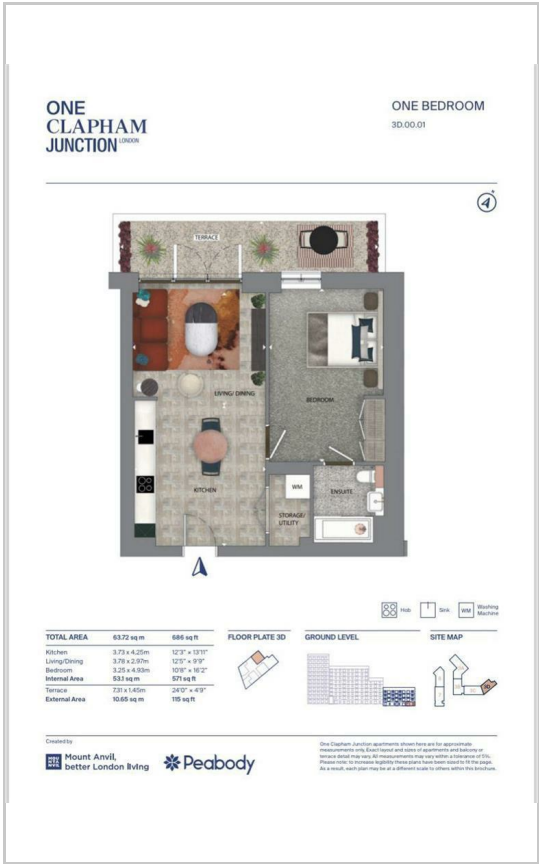

Energy Efficiency Graph



These particulars, whilst believed to be accurate are set out as a general outline only for guidance and do not constitute any part of an offer or contract. Intending purchasers should not rely on them as statements of representation of fact, but must satisfy themselves by inspection or otherwise as to their accuracy. No person in this firms employment has the authority to make or give any representation or warranty in respect of the property.